



*** REQUIRED INFORMATION**
Please answer all relevant questions. Incomplete order forms will delay the ordering process.

* Dealer: _____		* Date: _____
* Purchase Order #: _____		
* Contact Person (for questions about this order): _____		
* Phone: _____	* Email: _____	
* Palmer Model #: _____	Notes (5,000 character limit): _____	

*** SELECT A FINISH** (choose only one)

Plated Finishes	Polished Chrome Polished Nickel Satin Nickel Aged Nickel	Living Finishes	Polished Brass Un-Lacquered Satin Brass Waxed Aged Brass Un-Lacquered Oil Rubbed Bronze	Coated Finishes	Polished Brass Lacquered Satin Brass Lacquered Aged Brass Lacquered Matte Black	PVD Finishes	Polished Brass PVD Satin Brass PVD Polished Gold PVD Satin Gold PVD
-----------------	---	-----------------	--	-----------------	--	--------------	--

SPECIFY YOUR 5 COUNTERTOP DIMENSIONS

please enter measurements in Decimal Inches Only - No Fractions or Metric

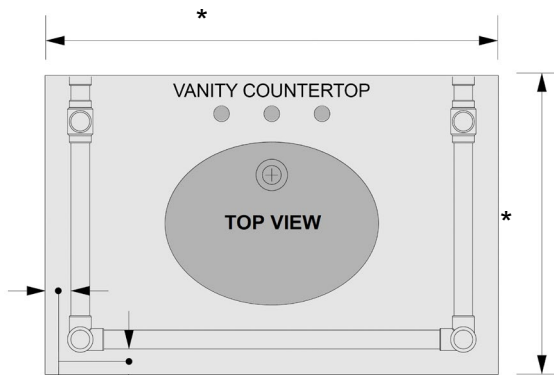

*** SPECIFY OVERHANG OF COUNTER EDGE TO OUTSIDE EDGE OF TUBING**

choose only one:

1.25" Recommended Overhang
for Countertops up to 48" wide

1.5" Recommended Overhang
for Countertops over 48" wide

Other _____

COUNTERTOP THICKNESS & OVERALL HEIGHT

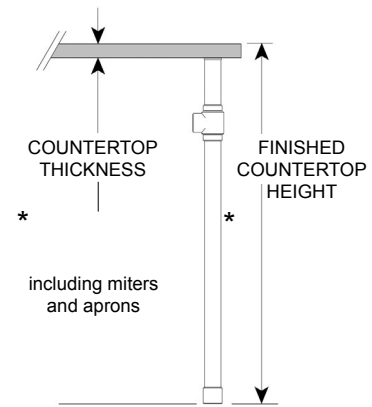

OPTIONS & ACCESSORIES

SHELF OPTIONS:	Tubular Metal: TS	Standard Glass: GS-SC	Low-Iron Glass: GS-LI	Teak Wood: WS
→ PLEASE NOTE: ALL SHELVES REQUIRE SHELF SUPPORTS ←				
SHELF SUPPORTS:	Rail: SS-R	Low Profile: SS-LP	Glass Clip: SS-GC	Split Collar: SS-SC
FRONT RISER:	FR-1 (1 riser - centered)	FR-2 (2 risers - offset)	Should be considered for counters 48" or wider (2-leg or 4-leg)	
SPLIT DIAMETER:	SD (1.5" dia. legs & 1.0" dia. horizontals)			
ADA COMPLIANT:	ADA (contact Palmer)			
CLEAR ACRYLIC ROD:	Horizontals, Legs, & Risers: ACRHL	Legs Only: ACRL	Horizontals Only: ACRH	
REEDED TUBING:	Horizontals, Legs, & Risers: RTHL	Legs Only: RTL	Horizontals Only: RTH	
HAMMERED BALLS:	Hammered Balls on Front Legs	Hammered Balls on Rear Legs/Risers	Hammered Balls on Rail Style Shelf Supports	
WALL BRACKET:	Standard aluminum wall bracket included with all leg systems	Heavy Duty Bracket: WBHVY	Solid Brass Finished: WBSTDB	
TOWEL RAIL:	Left Side: TRL	Right Side: TRR	Both Sides	
TP HOLDER:	Left Side: TPL	Right Side: TPR	Both Sides	

☐ **RUSH SERVICE REQUESTED:** please contact Palmer for Rush Service surcharges and policies

Signature: _____
for authorized Palmer dealers only All Palmer products are custom made and are NOT returnable

Clear Form

OPTIONAL CHOICES
Please select from the available options and accessories